

**Greater St. Louis Area Council BSA
Parent & Pal Campout 2019**

A Parents' Guide...

Cub vs. Wild!

**Camp Warren Levis, Godfrey, IL
April 26-28**

Welcome and Thanks!

Welcome to the 2019 Parent & Pal! We are honored to provide you with what will be an amazing camping and outdoor opportunity for you and your Scout.

Our theme this year is outdoor survival skills and will offer you and your Scout opportunities to safely participate and learn important skills for outdoor adventure. As part of this weekend, you will participate in programs like BB guns, archery, fire building, conservation, crafts, and map and compass games.

What to expect when you arrive at camp:

- You will be greeted by a staff member as you drive in who will direct you to your check in area.
- You will be directed to your camp site and allowed to unload your vehicle (weather permitting) after checking in at registration. **NOTE:** Your vehicle may be trapped at the campsite until we can safely move all the vehicles back to the parking lot. This will be conducted by Staff at various times throughout the evening. At approximately 6:45pm we will need **ALL** vehicles moved back to the parking lot.
- We are changing registration this year and will not collect Health Forms until after you have moved into your Camp Site to improve the flow of traffic at the entrance. You will be **REQUIRED** to turn this in prior to the parent's meeting Friday evening.
- There is a **MANDATORY** parent's meeting at Swaim Lodge on Friday evening. We will be providing a movie and supervision during this meeting so you are free to attend "child-free."
- Please read all the information contained in this packet **PRIOR** to arriving at camp and let us know if you have any additional questions or concerns.

At the conclusion of camp, you will be asked to complete an evaluation. Evaluations are a critical tool used by Directors and the Council to constantly improve our programs. Your time and thought are greatly appreciated as we strive to provide the best possible program for your Scouts.

Yours in Service,

Mary Curry Barton, Camp Director

Brad Nipper, Program Director

Laura Enge, Staff Advisor

And ALL of the 2019 Parent & Pal Staff members

CAMP WARREN LEVIS

Address: 5500 Boy Scout Lane
Godfrey, IL. 63035
Phone: 618-567-4407

Location and Directions

From the intersection of I-270, I-255, and IL-255 between Glen Carbon and Pontoon Beach, proceed north on IL-255 for 10 miles. Take exit 10 for IL-111/IL-140 towards Alton/Bethalto. Proceed approximately 4 miles to IL-111N/IL-3N/Homer Adams Parkway and turn right. Proceed 4.5 miles on Homer Adams Parkway until it comes to a t-intersection at Delmar Ave. Turn right at Delmar Ave/IL-3N and proceed 1.4 miles to Boy Scout Lane. There is a BP gas station on the corner of IL-3 and Boy Scout Lane. Turn right at Boy Scout Lane and proceed 0.6 miles to camp entrance. Park in the grassy field just to the right after entering the camp. Do not proceed beyond the parking lot without a vehicle pass.

History of Camp Warren Levis

Camping and outdoor activities have been a main part of the program at Camp Warren Levis since its beginning 80 years ago. Camp Warren Levis was originally owned by the Piasa Bird Council. The Piasa Bird Council's first camping area was called Camp Hawley, and was located just north of Route 100 in Godfrey, IL. Camp Hawley was established in May 1921 at Rocky Fork on Grafton Road. Camp Hawley was on a site that was used many years before as a slave refugee station. The first summer camp was held on July 11, 1921 and thirty scouts attended. Camp Hawley became the sole property of the Boy Scouts when deed was transferred by Andrew T Hawley on April 1, 1924. 160 acres of land in Godfrey, IL, was added by Mr. and Mrs. George Levis in memory of their son, Warren, who died in 1906. The council named the camp in his honor. Dedication of Camp Warren Levis and the first summer camp took place on July 7, 1924. In 1945, a capital development plan was initiated for the camp, and a lake was built along with other facilities. Currently the camp offers dining hall meals, a swimming pool, shooting sports area, handicraft and nature areas. In 1984, the COPE (Challenging Outdoor Personal Experience) Course was constructed. In 2001, the course was remodeled adding additional challenges and a 400-foot zip line along with a climbing/repelling tower and rock wall. Today, Camp Warren Levis is on 285 acres and is home to Boy Scout and Cub Scout programs in the former Lewis and Clark Council, now Greater St. Louis Area Council.

Camp Warren Levis

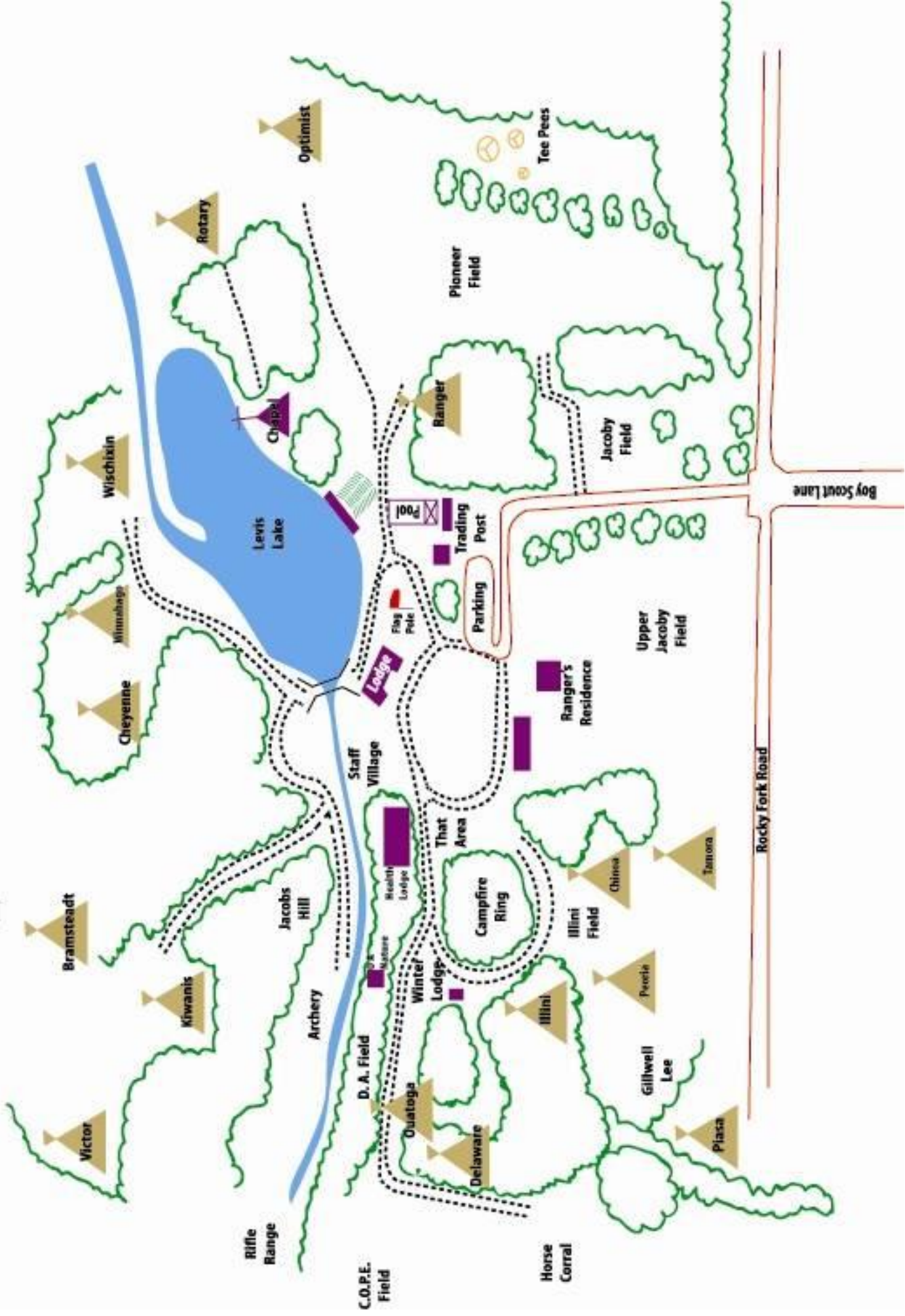

WHAT TO BRING TO CAMP

Rain gear
Non aerosol insect repellent
Money for Trading Post (\$10-\$30 for snacks and souvenirs)
Backpack or Day Pack
Tent
Class A Uniform (if your Scout has one, for flag ceremonies)
Class B Uniform or any other Scout t-shirts
Closed toe shoes (no crocs, sandals, flip flops or Heelys)
Extra pair of shoes
Sleeping bag and sheet(s)
Ground cover
Lawn Chair
Towel(s)
Toiletries
Medication (if required) *Camp Medic must be aware of this at Check-in
Extra Clothing as desired (Prepare for the weather conditions)
Sunscreen
Pillow
Fishing Tackle and Bait (if you wish to fish during free time)
Completed BSA Health History Parts A and B of Form 34605

You may also want to bring a wagon, if you have one, to carry your gear to and from your campsite.

ARRIVAL AND CHECK-IN AT CAMP

On Friday, participants will be allowed to start check-in as early as 4pm and ALL campers should plan to arrive **no later than 6pm**. The camp will not be open to participants prior to 4pm. (Except by reservation through the Camp Director or Program Director.)

Parking will only be in the designated areas and it important to follow the directions of camp staff in the parking area. Staff members in the parking lot will direct parents to check-in first with their COMPLETED Health Forms. **Do not unload camping gear until directed by a camp staff member.**

The parking areas will not be adjacent to the campsites. Additionally, due to safety and other concerns, it may not be feasible to allow personal vehicles down camp roads to the campsites to load and unload. All vehicles on camp roads past the parking lot must have a pass. Whether or not driving to campsites is allowed is determined case-by-case by each Camp Director taking into account ground conditions, camp size, and other factors. When packing, plan on having to carry all gear to the campsite. A child's wagon can be very useful for carrying camp gear. Families with special needs, contact the Camp Director or Program Director for a driving pass.

Health Histories will be collected on the first day of camp. Ensuring Health Histories are complete (Parts A and B for all Cub Scout camps) and signed will expedite the check-in/ arrival process. **All registered participants, including adults and siblings, must have a completed Health History.**

During check-in, a distinctive form of identification (ex. wristband or name tag) will be handed out to each paid participant. **All persons, regardless of age, must wear this as identification at all times on camp property.** Camp staff will also have a distinctive identification. Anyone without his or her identification will be asked to leave the camp property. Please notify the Camp Director or Program Director of anyone not having the proper identification. This is for EVERYONE'S safety.

*****Should anyone need access to power for medical reasons such as CPAP or other devices for sleeping, please let the Camp or Program Director know as soon as possible (email: Mary.elizabeth.curry@gmail.com). Limited access to these are available and will need to be planned for. For medications/ medicines that need to be refrigerated, the Camp Nurse will be able to keep these items secured until they are needed. It is the responsibility of the adult to notify the Camp Nurse and procure the medicine at the appropriate times, not the Camp Nurses responsibility to remind you when to administer medicine to your Scout or yourself.****

MEALS

There will be no dinner served on Friday night at Parent & Pal. A light snack will be served during or following the evening activity. Families are welcome to bring their own food to prepare dinner at their campsite. (See below for ground fires.) Above ground fire pits and small propane grills are allowed.

The following meals will be served at this Family Camp:

- Friday Night – Cracker Barrel (light snack)
- Saturday – Breakfast, Lunch, Dinner, Cracker Barrel
- Sunday – Breakfast

All camp supplied meals will be eaten in the camp Dining Hall. Families should line up in front of the flag pole outside the Dining Hall for a group grace prior to entering. Remove hats prior to entering the Dining Hall. Meals are typically served cafeteria style. Do not go up for seconds until the Head Chef or Dining Hall Steward calls “Seconds”. **Tables are bussed and cleaned by participants.**

If you have food allergies or special dietary needs and did not indicate at registration, please send an email to the Camp Director so arrangements can be made to ensure a proper meal is available. Mary.elizabeth.curry@gmail.com

Gateway Traders

A camp store, known as Gateway Traders, will offer snack items and sodas. Extra camp T-shirts and other Scout items will also be available.

GENERAL CAMP RULES

- **ALWAYS** have a buddy, including visits to the latrine.
- Youth must remain with their family. If a youth must leave the family, such as to use the latrine, an adult family member must be informed. Always have a buddy.
- Adhere to the Scout Oath and Scout Law at all times.
- Adhere to the seven principles of Leave no Trace
- Be courteous at all times, especially when others are speaking or when waiting in line.
- Obey all “off limits” signs and announcements.
- Flashlights must be aimed at the ground in front of the person at all times. Please do not shine your flashlight in other peoples or animals’ eyes.
- Abide by the quiet time listed in the schedule.
- ALL campfires must be out by 10:30PM. Please follow proper fire etiquette and you **MUST** use the supplied fire rings. Fires **MUST** be attended at ALL times and should be cold before leaving them or going to sleep.

SPECIAL RULES FOR ARCHERY AND BB ACTIVITY AREAS:

- Use only marked entrances and exits into and out of perimeter of Archery and BB range.
- Always ask for and receive permission to enter BB and Archery ranges from camp staff member at that activity area before entering.
- Camp staff at the Archery and BB ranges will explain other safety rules.
- Although there is no minimum age set by BSA for shooting sports participation at Family Camp, station leaders can use discretion when determining whether young non-scout children should shoot. If a young child is allowed to participate, the parent must assist the leader to insure the safety of all participants.

ADDITIONAL CAMP RULES FOR PARENTS AND STAFF

- Parents and Staff must follow the General Camp Rules.
- Adults may only smoke in their cars in the parking lot, out of sight of youth. Place cigarette butts in vehicle ashtrays. If parents leave to smoke, insure youth are adequately supervised prior to departure.
- No alcoholic beverages, drugs or fireworks are allowed in camp.
- No firearms, knives or other weapons are allowed in camp other than those brought by staff for specific activities. Parents may have a small pocketknife. Cub Scouts with a Whittling Chip may also have a small pocketknife.
- No swearing or abusive language is allowed in camp.
- Camp staff will wear class A uniforms or camp staff t-shirts.

PARENT EXPECTATIONS

- Lead Scouts and siblings from one camp activity to the next according to the camp schedule.
- Assist station leaders with planned activities as requested.
- Assist station leaders with behavior management as needed.

GROUP ASSIGNMENTS AND PARTICIPATION

Every effort will be made to keep families from local Packs together, but in some cases, families from different Packs or towns may be grouped together. Encourage youth from different units to cooperate during activities. Group assignments are distributed with registration packages. Do not change groups without Camp/ Program Director approval.

Adults are encouraged to participate in activities with the youth where the situation allows; youth will enjoy seeing adults shoot BB's or play games with them. However, if time becomes an issue at a station, give priority at the activity to the youth participants. Remember; at Family Camp siblings have paid the same fee to participate as Scouts, so afford them an equal participation opportunity. Due to safety concerns, at the discretion of the Station Leader, pre-school aged family members may not be allowed to participate in certain activities.

EMERGENCY PROCEDURES

All staff, including youth staff, are trained in camp-specific emergency procedures. Parents may be asked to assist staff, but need to follow staff directions at all times.

The Emergency Assembly Area for Camp Warren Levis is the flagpole in front of the Dining Hall. The Emergency Shelters are the basement of the Dining Hall and the restrooms under the Trading Post.

If out in the open, lie flat in a ditch or depression. The area below the dam spillway (creek, nature trail, and shooting range) is prone to flooding in heavy rain. If caught below the dam, get to higher ground if it is raining or has rained.

FIRST AID

There is a Camp Health Officer on site. The Health Officer will be at the Health Lodge or Camp Headquarters, or can be reached by radio or cell phone. For a minor injury, an adult should bring the injured person to the Health Lodge or Headquarters, after insuring other campers under his/her care will be adequately supervised.

When the injured person cannot be moved, the Health Officer should be notified by radio or cell phone (if available) or by sending an adult messenger to camp headquarters.

The Camp Health Officer will inform the Camp Director or Program Director of all injuries or illness at camp. If necessary, notification and transportation to a local hospital will be arranged by the Camp Health Officer and Camp Director. When required, the Camp Director will inform the Scout Executive. When required, notification of parent, guardian, or nearest relative is the responsibility of the Scout Executive or designated representative. Local authorities (fire, police, etc) will be notified by the Camp Director when dictated by the situation.

SEVERE WEATHER

Most camp activities will continue in light to moderate rain. In case of heavy or continuous rain, rainy day activities may be substituted. Station Leaders are expected to have alternative activities ready.

The Staff Advisor and Camp Director are equipped with severe weather radios and have internet weather resources available. In case of inclement weather, they will closely monitor the situation and if severe thunderstorm, tornado watch or warning, or other severe weather is approaching, they will take appropriate action to insure all personnel have time to take shelter.

In the event of severe weather, upon hearing one long bell or horn, all adults and Scouts will proceed to the designated assembly area.

LOST CHILD

If it is determined that a child is not with his or her group and is nowhere in the general area of the group, send an adult or two older youth to notify the Camp Director or Program Director immediately. The Director will implement lost child procedures for the specific camp facility. Each camp has a specific written plan for lost children. The Director may request the assistance of parents.

FIRE

A fire in or near an activity area should be reported immediately to the Camp Director or Staff Advisor so firefighters can be called. The parent's primary responsibility is to escort youth safely out of danger, checking attendance to insure all group members are present. If anyone is not accounted for, an adult should quickly search the immediate area, while other parents return to the camp assembly area with their group. If the missing person is found, he/she should be led to rejoin his/her group. If the missing person is not immediately found, the Lost Child Plan is put into effect. If the camp assembly area is not safe, an alternate location will be announced. In case of fire, it is critical to have a complete accounting of all persons on camp property.

YOUTH PROTECTION

All Leaders; including Camp Director, Program Director, Station Leaders and Assistants, Trading Post, Kitchen Staff and Health Officer; must have completed BSA Youth Protection Training within the past two years. Youth Protection Training is not required for parents but is highly recommended.

In accordance with BSA Youth Protection Guidelines, all adults (whether registered with BSA or not) will abide by the following:

Note: Youth staff members under the age of 18 are considered youth for the purposes of this section.

Two-deep leadership is required at all times

- Two adults must be present with youth at all times
- At least one adult must be at least 21 years old

No one-on-one contact between youth and adults

- If a private conference is required, such as for disciplinary reasons, conduct the conference in full view of other adults and youth

Respect the privacy of youth and adults

- No adults are allowed in youth restrooms or changing areas; no youth are allowed in adult restrooms or changing areas
- If health or safety require an adult to enter a restroom or changing area, then two adults are required to enter the area
- If a family includes a preschooler or a person with special needs that requires assistance, a family changing area will be provided only for the parent and the person requiring assistance. Other family members must change in their appropriate areas.

Separate accommodations

- No adult is permitted to be in the tent of a youth other than his/her own family

Appropriate attire

- All youth and adults must wear clothing appropriate to the activities

Constructive Discipline

- Discipline should be constructive and reflect Scouting values
- No corporal punishment

If at **any** time abuse or neglect is suspected, notify the Camp Director who will immediately notify the Scout Executive

LEAVE NO TRACE

1. Know before you go – Come prepared for the weekend
2. Stick to the path – Camp and walk on durable surfaces.
3. Trash your trash – Leave only footprints, we can provide small trash bags if you need one
4. Leave nature in nature – Sticks and other pieces of nature need to stay where you found them
5. Be careful with fire – use our supplied fire rings, don't leave a fire unattended
6. Respect other visitors
7. Respect wildlife

EMERGENCY PHONE NUMBERS

Position	Phone
Camp Director- Mary Curry Barton	618-660-4234
Program Director- Brad Nipper	618-531-7835
Camp Health Officer- Dawn Hurst	618-409-5559
Professional Staff Advisor- Laura Enge	815-531-9659
Emergency	911